



# City of Chico

## SR32 Widening Project (Phase 1)

Volume 10

August 12, 2014

# State Route 32 Widening Project (Phase 1)

## Weekly Update

### **Introduction**

Following is the Tenth (10<sup>th</sup>) Volume of the SR32 Widening Project (Phase 1) weekly update newsletter. The purpose of these updates is to share detailed information regarding scheduling and construction activities anticipated for the upcoming week. If you do not wish to receive updates, you may opt out by sending staff a quick e-mail with that instruction. Alternatively, if you know of other interested parties that would appreciate being added to the list, please send an email request to: [update32@chicoca.gov](mailto:update32@chicoca.gov)

### **Dead Horse Slough Bridge Widening Work**

Pile driving work has been completed. Work has now proceeded on the superstructure portion of the bridge widening, including the construction of the bridge abutments and then into the new bridge deck. Over the next couple of months, this bridge will begin to take shape from the foundation up through the new bridge deck and concrete barrier. Please drive with caution around the Dead Horse Slough bridge and be sure to pay attention to traffic control devices and signs. Material deliveries, as well as construction equipment will be entering and exiting the roadway in order to access the ongoing work at this location.

### **Roadway Widening Work**

The new roadway grade has been cleared and soils have continued to be hauled in and placed in order to start building up the new roadway embankment. More activity should be noticed along the north side of the existing roadway starting next week between the Park and Ride and Forest Avenue. Roadway embankment is the base material that is used to build up the new roadway grade, consisting of mostly soil and aggregates. This portion of the work will be ongoing for the next few months. Once the roadway embankment is complete, the roadway structural section will be placed on top of this, including 1.6' of Aggregate Base and 0.55' of Asphalt.

### **Precast Concrete Sound Wall**

The decorative precast concrete sound wall is currently being fabricated and is expected to ship to the jobsite in the next week or so. Minor grading work will be completed in order to prepare for this installation. The sound wall will consist of precast concrete posts set into 12" diameter drilled holes and then set with fresh concrete to hold in place. These posts will be spaced at 6'-4". From post to post, vertical decorative precast concrete panels will be installed as the actual sound wall material. This is a laborious item of work and will be ongoing for the next several months and will begin at 8<sup>th</sup> Street and go all the way to the West side of the El Monte intersection along the north side of the right of way. The wall height will vary from 8' to 10' in total height.

### **Stage 1 Traffic Alignment Shift**

On the night of Monday, July 14, temporary pavement striping was placed to shift Highway 32 traffic slightly to the south, in order to create more room for the new roadway widening work to be performed. You will also notice that the temporary signal system at the intersection of Forest Avenue and Highway 32 has been activated and the previously existing traffic signal poles have been removed. It is anticipated that this traffic alignment will be in place for the next few months. Please be sure to travel through this area with caution, paying attention to the revised traffic alignment and devices, as well as the other suggested driving tips through a construction zone as referenced at the bottom of this newsletter.

**CONTINUED ON NEXT PAGE**

### Safety Tips

- ✓ Drive slowly and carefully through the construction area.
- ✓ Be alert for construction workers and large equipment, such as backhoes, graders and trucks.
- ✓ Obey all construction signs and directions from traffic control flaggers.

The City appreciates your patience and understanding during the project. Please feel free to contact City staff or the Contractor should you need additional information. The Contractor will notify residents & businesses at least 10 days prior to the commencement of any construction activities that may affect or is in the immediate vicinity of their property. For more information, please refer to the City Capital Project Services website at [www.ci.chico.ca.us](http://www.ci.chico.ca.us) Pull down the Departments drop down menu and select Capital Project Services. The same web page can be accessed at the following link: [www.ci.chico.ca.us/capital\\_project\\_services/home\\_page.asp](http://www.ci.chico.ca.us/capital_project_services/home_page.asp)

<b>CONTACT PHONE NUMBERS (Area Code – 530)</b>	
Capital Project Services Department	879-6900
Police Dispatch (use this number for immediate assistance from 5PM - 8AM)	895-4911
<u>Design Questions</u>	
Bob Greenlaw, Senior Civil Engineer	879-6930
Craig Murray, Associate Civil Engineer	879-6931
<u>Construction Issues</u>	
Tyler Bodnar, Construction Inspector	879-6936
Brendan Ottoboni, Resident Engineer	(925) 628-6196
<u>Knife River Construction (Contractor)</u>	
Jim Bennett (Project Manager)	891-6555
24-hour Contractor contact	891-6555

## Area of Construction Activities (June2014-January 2015)

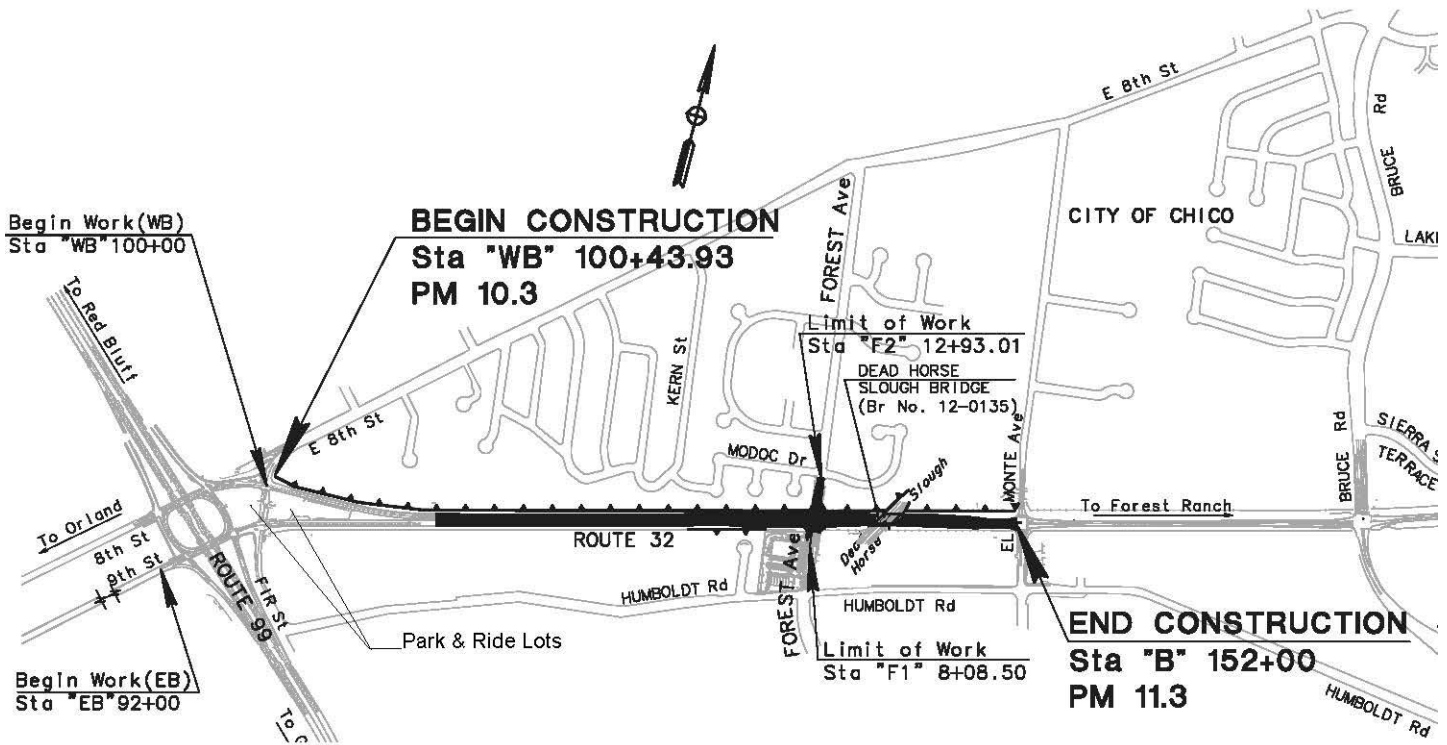

END